

WMP

VIDEO MOUNT PRODUCTS

Instruction Sheet For:

PM-3 & PM-3B

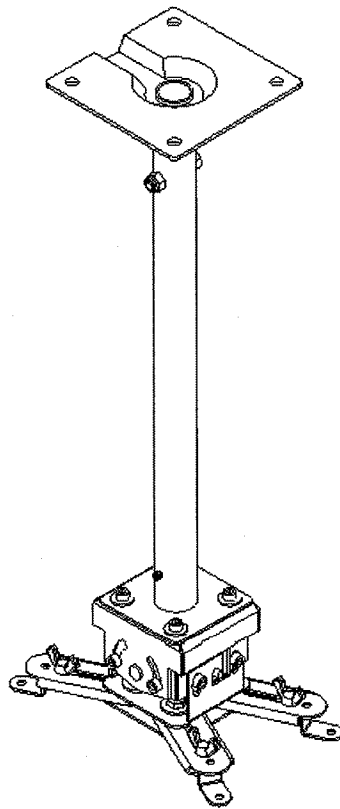

For more information, please contact us at:
345 Log Canoe Circle, Stevensville, Maryland 21666
Toll Free: 877.281.2169 Phone: 410.643.6390 Fax: 410.643.6615
www.videomount.com

VMP

VIDEO MOUNT PRODUCTS

UNIVERSAL PROJECTOR MOUNT

PM-3

NO.	Part Name	QTY.
1	Ceiling Mount Bracket	1
2	Allen Key M3	1
3	Allen Key M5	1
4	Allen Screw M6x10	12
5	Washer $\phi 6.5 \times \phi 19 \times T1.6$	12
6	Flush Ceiling Plate	1
7	Projector Mount	1
8	Fixing Plate	4
9	Cross Screw M4x8	4
10	Cross Screw M5x8	4
11	Cross Screw M6x8	4
12	Brake screw 1/4"x1/2"	1
13	Washer $\phi 8.3 \times \phi 19 \times T1.6$	4
14	Hex Wood Screw 5/16"x2.5"	4

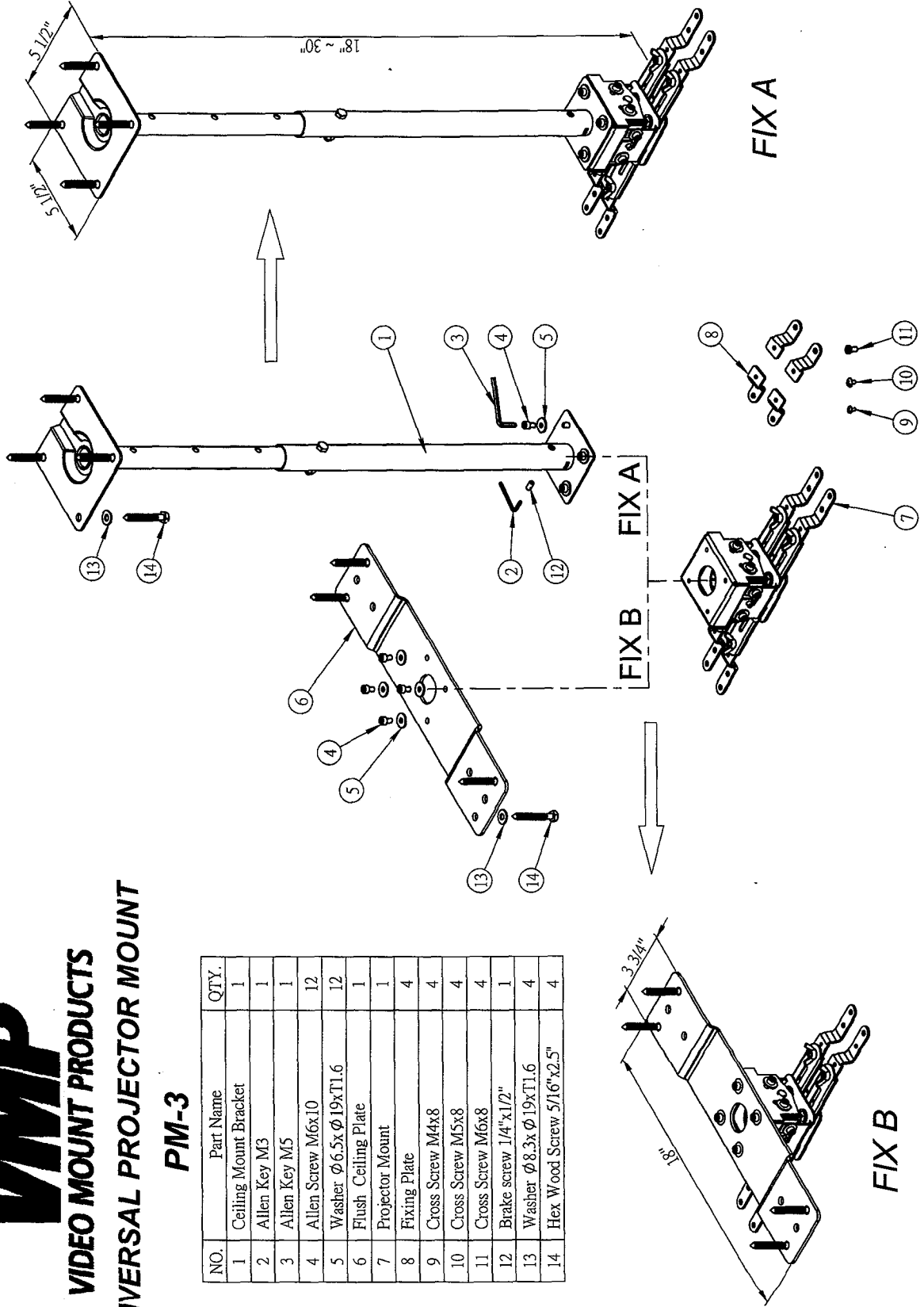

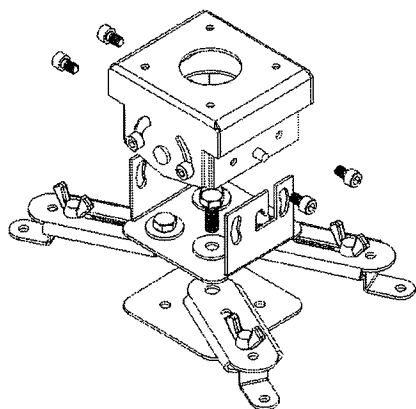

Step 2: Removing a leg off the projector mount

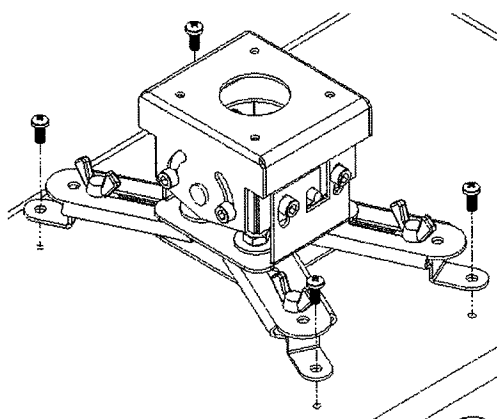

Step 3: Connecting the projector to the projector mount

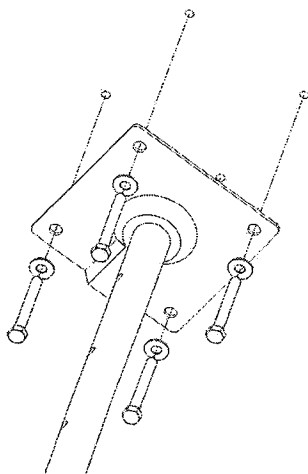

Step 4: Connecting the ceiling mounting bracket to the ceiling

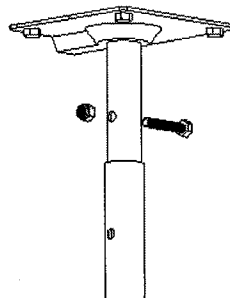

Step 5: Adjusting the drop length of the ceiling mounting bracket

Step 1

Before starting, lay out all parts to your mount and match them to the parts list provided. Verify that you have all your parts before attempting to assemble the mount.

Step 2

Determine how many mounting holes your projector has. If it has less than 4 then you should remove the excess leg(s). To do this remove the socket head screws from the sides of the projector mount which have the J shaped slot cut into them. Then lift off the top of the projector mount. Now remove a hex head screw for each leg you want to remove. Then pull out the excess leg(s). Reattach the top of the projector mount to the bottom.

Step 3

Now connect the projector to the feet of the projector using the mounting screws provided with the mount. You may have to remove the wing screws in order to maneuver the feet into the correct position. If you do so remember to reattach them once you have done so.

If you are using the ceiling mast,

Step 4

Mark the ceiling or desired mounting surface in preparation of installation of ceiling plate. If mounting to wooden ceiling joists, pre drill pilot holes using a 7/32" drill bit. Attach the ceiling plate to the wooden ceiling joist using the 5/16" by 2.5" long lag screw and washer. **WARNING: Please verify that your mounting surface will support the combined weight of your mount, mounting hardware, and flat panel. Also verify that the mounting surface is safe to drill through. Please note only mounting hardware for mounting to wooden ceiling joists will be provided with the unit. If mounting to a surface other than wooden ceiling joists then other hardware will be required. If in doubt or uncertain about any of the above, please contact a professional installer.**

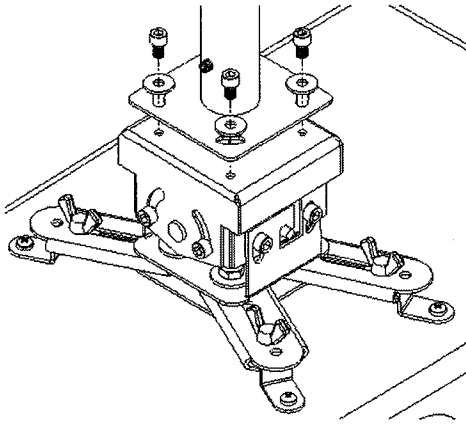

Step 6: Attaching the projector mount to the ceiling mount bracket

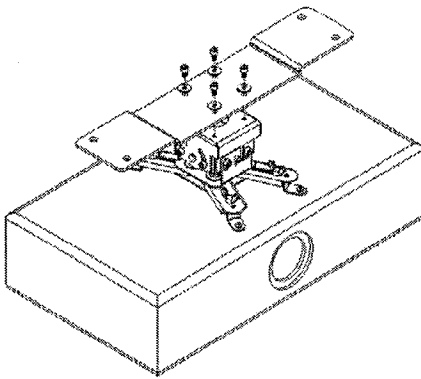

Step 7: Attaching the projector mount to the flush mounting plate

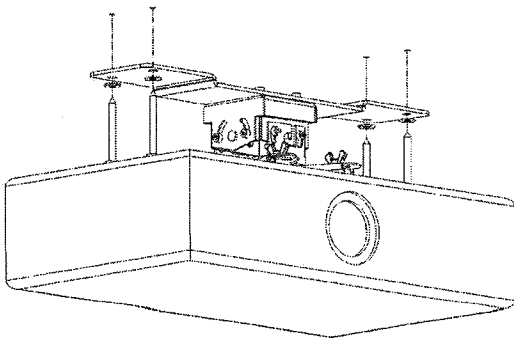

Step 8: Attaching the flush mounting plate to the ceiling

Step 5

To adjust the drop length of the mast, remove the 5/16" screw and slide the lower mast to line up with another set of holes in the upper mast. Then reinsert the 5/16" screw and retighten the nylon nut.

Step 6

To attach the mast to the projector mount use the socket head screws and washers and screw the top of the projector mount to the square plate.

If you are using the flush mounting plate,

Step 7

Attach the flush mounting plate to the top of the projector mount by using the socket head screw and washers.

Step 8

Mark the ceiling or desired mounting surface in preparation of installation of flush mount plate. If mounting to wooden ceiling joists, pre drill pilot holes using a 7/32" drill bit. Attach the flush mount plate to the wooden ceiling joist using the 5/16" by 2.5" long lag screw and washer. It may be necessary to remove the bottom half of the projector mount in order to get access to the flush mounting plate. Instructions on how to do so refer to step 2.

WARNING: Please verify that your mounting surface will support the combined weight of your mount, mounting hardware, and flat panel. Also verify that the mounting surface is safe to drill through. Please note only mounting hardware for mounting to wooden ceiling joists will be provided with the unit. If mounting to a surface other than wooden ceiling joists then other hardware will be required. If in doubt or uncertain about any of the above, please contact a professional installer.

Please verify that all nuts and screws are securely tightened.

Enjoy Your Mount!

WARNING: The installer of these products must verify that the mounting surface, ceiling or wall, will safely support the combined weight of all attached equipment and hardware. Video Mount Products will not be held liable for the improper use or installation of its products.

VMP
VIDEO MOUNT PRODUCTS