

WMP

VIDEO MOUNT PRODUCTS

Instruction Sheet For:

IWB-1

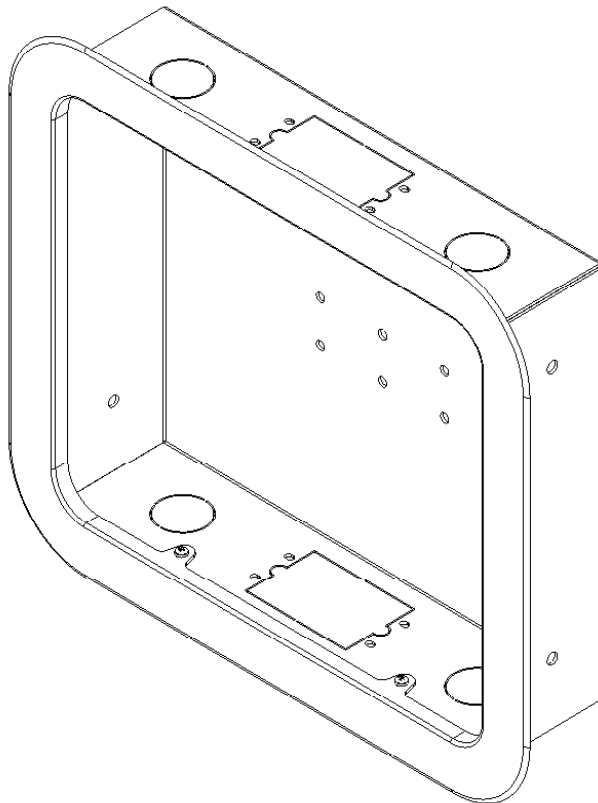

*For more information, please contact us at:
325 Log Canoe Circle, Stevensville, Maryland 21666
(T) 410.643.6390 / (F) 410.643.6615
www.videomount.com*

IWB-1

ITEM NO.	DESCRIPTION	QTY.
1	Wall Box	1
2	Mount Supports	2
3	Screw M8*P1.25*L12	4
4	Trim Cover	1
5	Screw M4*P0.7*L10	4
6	Lag Screw M8*L50	4
7	Large Mounting Plate	1
8	Small Mounting Plate	1
9	LCD-2537 Pivot Bracket	1
10	LCD-1 Pivot Bracket	1
11	Adjustable Screw 1/4"-20UNC*L2"	1

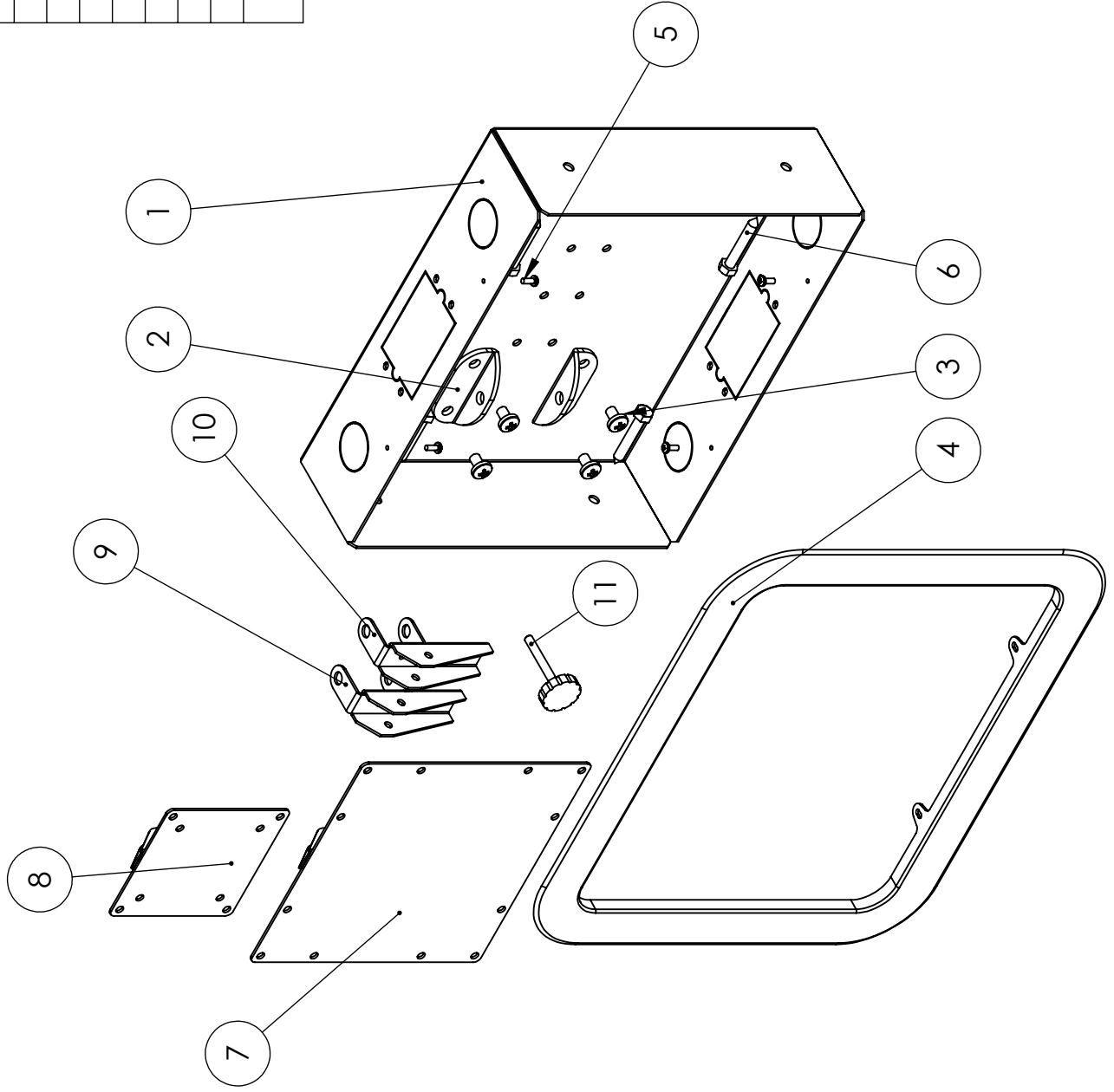

WARNING: It is HIGHLY recommended the installation of the IWB-1 be installed by a qualified professional, as the installation process can be dangerous and result in personal injury or death if done improperly. If at any point you are unsure about what you are doing, STOP and contact a qualified professional.

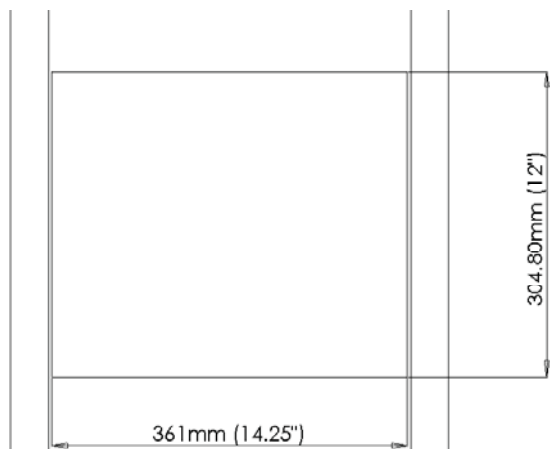

Step 3: Outline of the cutout for the IWB-1

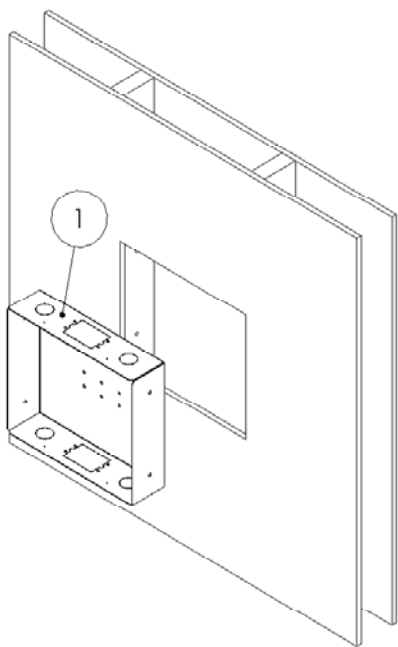

Step 5: Inserting the wall box into the wall

Step 1

Before starting, lay out all parts to your mount and match them to the parts list provided. Verify that you have all your parts before attempting to assemble the mount. Please identify which color your LCD-1/LCD-2537 is, silver or black, and only use the parts #7-11 or #12-16 which are the correct color for your mount. Set aside the other color of parts. If you wish to paint the wall box (1), mount supports (2) and trim cover (4) to match or wall or mounting surface please do so at this time.

Step 2

Identify a proper installation site of the IWB-1. **Note: The IWB-1 is designed to go in between two wooden studs with 16" centers. There will not be enough space remaining to the side of the IWB-1 for electrical wires/cables, plumbing, ductwork or insulation. Please take this into account when locating the installation site.**

** Step 3 **

Use a stud finder to locate the desired studs and mark their locations. Center and level the housing and using the housing as a template draw around the edges of the box (1). Cut out the drywall within the drawn line.

Step 4

If installing electrical junction boxes into the wall box (1) please do so at this time using the knockouts in the top or the bottom of the box. Route any audio/visual cables through the knockouts also located on the top and bottom of the wall box (1) at this time as well.

Step 5

Insert the wall box (1) into the wall.

**** WARNING: ELECTRICAL SHOCK HAZARD! CUTTING OR DRILLING INTO ELECTRICAL WIRES OR CABLES CAN RESULT IN DEATH OR SERIOUS PERSONAL INJURY! Always make sure the area you are preparing to cut or drill into is completely clear of electrical wires before you proceed in order to prevent injuries.**

**** WARNING: EXPLOSION AND FIRE HAZARD! CUTTING OR DRILLING INTO GAS PLUMBING CAN RESULT IN DEATH OR SERIOUS PERSONAL INJURY! Always make sure the area you are preparing to cut or drill into is completely clear of gas, water, waste or any other plumbing before you proceed in order to prevent injuries.**

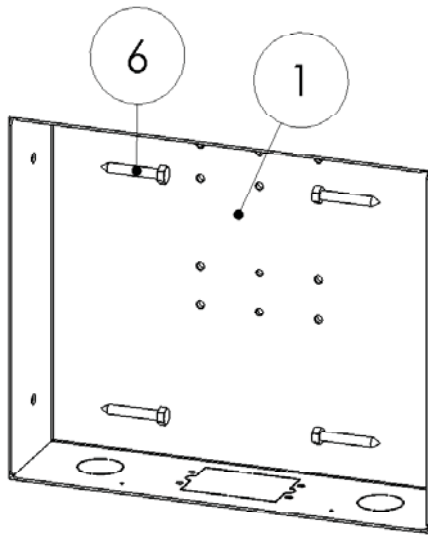

Step 6: Lagging the wall box into the studs

**** Step 6 ****

Pre-drill and attach the wall box (1) to the studs using the M8 lag screws (6) provided. *Note: It is very important the front of the box (1) is as flush as possible with the wall as to insure a proper fit for the trim cover (4).*

If you are installing a LCD-1 into the IWB-1 proceed to the next step. If you are installing a LCD-2537 into the IWB-1 proceed to step 9.

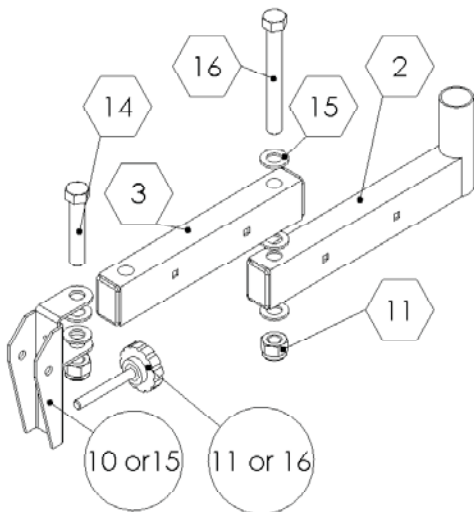

Step 7

Attach the front force arm (3) to the rear force arm (2) using the metal pin (16) washers (15) and nylon nut (11). Attach the LCD-1 pivot bracket provided with the IWB-1 (10) or (15) to the front force arm (3) using the 3/8" screw (14), washers (15) and nylon nut (11). Insert the adjustable screw provided with the IWB-1 (11) or (16) into the threaded hole of the pivot bracket IWB-1 (10) or (15).



Step 7: Assembling the LCD-1 arm

Key:

	IWB-1
	LCD-1



**** WARNING: ELECTRICAL SHOCK HAZARD! CUTTING OR DRILLING INTO ELECTRICAL WIRES OR CABLES CAN RESULT IN DEATH OR SERIOUS PERSONAL INJURY! Always make sure the area you are preparing to cut or drill into is completely clear of electrical wires before you proceed in order to prevent injuries.**

**** WARNING: EXPLOSION AND FIRE HAZARD! CUTTING OR DRILLING INTO GAS PLUMBING CAN RESULT IN DEATH OR SERIOUS PERSONAL INJURY! Always make sure the area you are preparing to cut or drill into is completely clear of gas, water, waste or any other plumbing before you proceed in order to prevent injuries.**

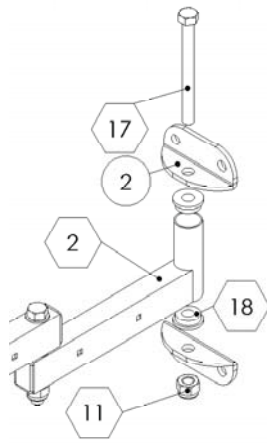

Step 8: Attaching the mount supports

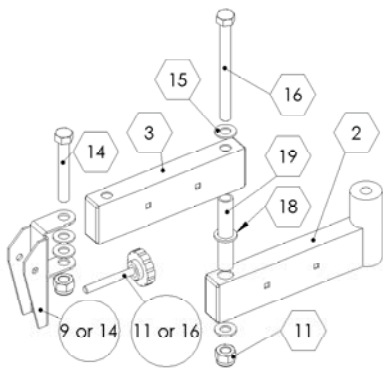

Step 9: Assembling the LCD-2537 arm

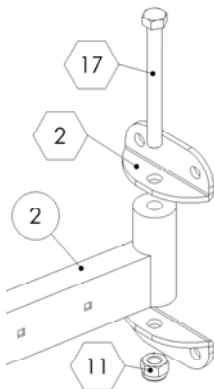

Step 10: Attaching the mount supports

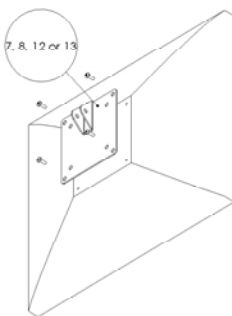

Step 11: Attaching the mounting plate

Step 8

Insert the end plugs (18) into the rear force arm (2) and use the long 3/8" bolt (17) and nylon nut (11) to attach the mount supports (2) to the bottom and top of the rear force arm (2). **Proceed to step 11.**

Step 9

Insert the longer spacer (19) into the rear force arm (2) and attach the front force arm (3) to the rear force arm (2) using the metal pin (16), 3/8" washers (15), 1/2" washer (18) and nylon nut (11). Attach the LCD-2537 pivot bracket provided with the IWB-1 (9) or (14) to the front force arm (3) using the 3/8" screw (14), 3/8" washers (15) and nylon nut (11). Insert the adjustable screw provided with the IWB-1 (11) or (16) into the threaded hole of the pivot bracket (9) or (14).

Step 10

Use the long 3/8" bolt (17) and nylon nut (11) to attach the mount supports (2) to the bottom and top of the rear force arm (2).

Step 11

Determine the VESA mounting hole pattern for your LCD. If the hole pattern is either 75 mm x 75 mm (about 3" x 3") or 100 mm x 100 mm (about 4" x 4") then you will use the small mounting plate (8) or (13). If the hole pattern is either 100 mm x 200 mm (about 4" x 8") or 200 mm x 200 mm (about 8" x 8") then you will use the large mounting plate (7) or (12). Attach the appropriate mounting plate (7), (8), (12) or (13) using the screws provided with the LCD-1 or LCD-2537.

Key:



IWB-1



LCD-1 or LCD-2537

WMP
VIDEO MOUNT PRODUCTS



Step 12A: Mount support location diagram

Step 12

Determine if you want the arm to fold left or fold right. If you want the arm to fold right you use the first and second column of holes. If you want the arm to fold left you use the second and third column of holes. Attach the mount supports (2) to the wall box (1) using the M8 screws (6). **Note: For the LCD-2537 you should use the first and third rows of holes. For the LCD-1 you should use the second and forth rows of holes.**

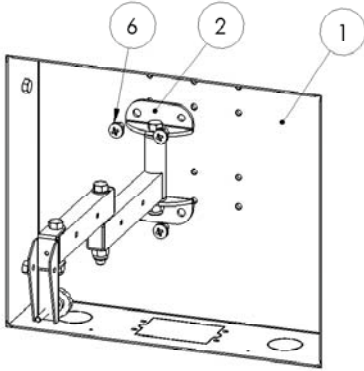

Step 12B: Attaching the mount supports to the wall box

Step 13

Attach the trim cover (4) to the wall box (1) using the M4 screws (5) provided with the IWB-1.

Step 14

Attach your LCD to the LCD-1 or LCD-2537 arm using the M6 screw LCD-1 or LCD-2537 (12) and nylon nut LCD-1 or LCD-2537 (13) to attach the mounting plate (7, 8, 12) or (13) to the pivot bracket (9, 10, 14) or (15).

Please verify that all nuts and screws are completely and securely tightened.

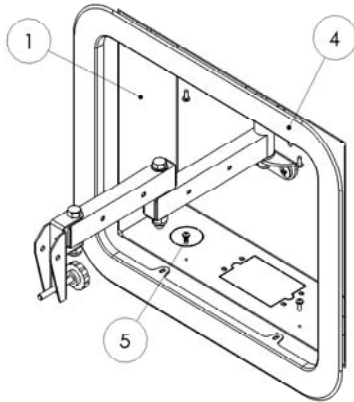

Step 13: Attaching the trim cover

Enjoy Your Mount!

WARNING: The installer of these products must verify that the mounting surface, ceiling or wall, will safely support the combined weight of all attached equipment and hardware. Video Mount Products will not be held liable for the improper use or installation of its products.

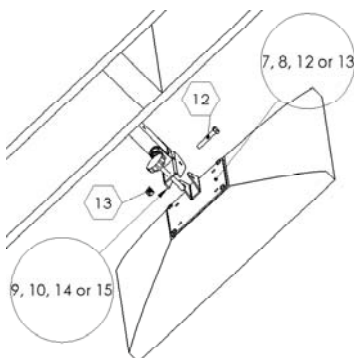

Step 14: Connecting the mounting plate to the pivot bracket

Key:

